

Dachlet  
7821 Morrison Road  
Greenleaf WI 54126 54126

Friday  
PREMIER  
Standard & JWW  
T2B

Saturday  
T2B

Sunday  
PREMIER  
Standard & JWW

**NOTE: Judge, Tom Slattery, is a VMO (volunteer measuring official). This means that all dogs not having a valid height card will need to be measured for this trial**

## PREMIUM LIST

**Manitowoc County Kennel Club**  
(A member club of the American Kennel Club)

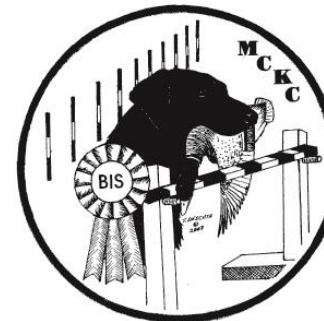

FRIDAY, SEPTEMBER 15, 2017 (#2017045011)  
SATURDAY, SEPTEMBER 16, 2017 (#2017045012)  
SUNDAY, SEPTEMBER 17, 2017 (#2017045013)

**Manitowoc Count Kennel Club Grounds**  
40 Albert Drive \* Manitowoc WI 54220  
Outdoors - Grass

FRIDAY TRIAL HOURS: 10:00 AM - 6:00 PM (CDT)

SATURDAY & SUNDAY TRIAL HOURS: 7:00 AM - 6:00 PM (CDT)

**These events are accepting entries for Mixed Breed dogs enrolled in the AKC Canine Partners Program**

**Friday – Master/Excellent Only (Standard & JWW)  
Premier Standard & JWW and T2B**

Entries limited to 250 runs

**Saturday – All Levels – Standard, JWW & T2B**

**Sunday – All Levels – Standard, JWW**

**Premier Standard & JWW**

Entries limited to 330 runs per day (Saturday & Sunday)

***Electronic Timing will be utilized at this trial***

***Method of Entry – First Received***

**Entries Open: Saturday, July 1, 2017, at 8:00 a.m. CDT**

Any entries received prior to that date & time will be returned,  
as well as any envelopes containing more than 10 entries

**No hand deliveries accepted during the first 24 hours after the trial opens.**

**Entries Close: Friday, September 1, 2017, at 6:00 p.m. CDT**

After which time entries cannot be accepted, cancelled, altered or substituted except as provided for in Chapter 11, Section 6 of the dog show rules



AMERICAN  
KENNEL CLUB

### AMERICAN KENNEL CLUB CERTIFICATION

Permission has been granted by the American Kennel Club for the holding of this event under American Kennel Club Rules & Regulations.

Gina M. DiNardo, Secretary

**Manitowoc County Kennel Club Officers**

President. . . . . Donna Kerr  
 Vice President. . . . . Karleen Cole  
 Secretary. . . . . Paul Cheteuti  
 2613 Oak Ridge Circle \* De Pere WI 54115 \* 920-336-9261 \* pachetcuti@att.net  
 Treasurer. . . . . Burl Cavanaugh  
 AKC Delegate. . . . . Romana Arnold  
 Board of Directors. . . . . Jim Powers, Jeanine Montag, Laurale Stern, Mike Brookins, Jim Van Egen, June Ashford, Kay Detampel, Sharon Mann, Jerry Claybrook

**TRIAL COMMITTEE**

Trial Chair: Burl Cavanaugh \* 1416 North Fifth Street \* Manitowoc WI 54220  
 920-682-1456 bpcava@ameritech.net

Members: Linda Bunkfeldt-Popp, Lynn Busse, Pat Cavanaugh, Kay Detampel, Donna Hlavachek, Annette McDonald, Jeanine Montag, Ginny Orheim

**JUDGE – All Three Days**  
**Tom Slattery (#53137)**  
 4490 Neal Avenue South \* Afton MN 55001  
**Friday ~ Master/Excellent, Standard & JWW and T2B**  
**Saturday ~ All Classes & Levels and T2B**  
**Sunday ~ All Classes & Levels**

**Running Order**

	<u>Friday</u>	<u>Saturday</u>	<u>Sunday</u>
Jump Heights	Ascending	Descending	Descending
Briefing/Walk Thru	10:45 a.m.	8:45 a.m.	8:45 a.m.
Judging Starts	11:00 a.m.	9:00 a.m.	9:00 a.m.
	T2B	T2B	Premier STD
	Premier JWW	Master/Exc JWW	Premier JWW
	Premier STD	Master/Exc STD	Master/Exc STD
	Master/Exc JWW	Open JWW	Master/Exc JWW
	Master/Exc STD	Open STD	Open STD
		Novice JWW	Open JWW
		Novice STD	Novice STD
			Novice JWW

**ENTRY FEES (Per Day)**

There will be a \$25.00 service charge for any returned checks.  
 No phone, fax or credit card entries will be accepted.

First entry of a dog \$18.00  
 (includes \$3.50 AKC event service fee on the first entry of a dog and the \$3.00 AKC event service fee on additional entries of that dog)  
 Additional entry of a dog \$17.00  
 JUNIOR HANDLER – Each Run \$12.00

A maximum of 10 entries per envelope is allowed. Envelopes with more than 10 entries and/or entries received prior to the opening date will be returned.  
 Paper entries received within 24 hrs. of the opening date & time must include postage or be metered and be delivered by a multi-state or multi-national postal or carrier service. No hand deliveries accepted during the first 24 hours after the trial opens.

**ENTRIES CLOSE:** 6:00 pm CDT, Friday, September 1, 2017, after which time entries cannot be accepted, canceled, altered, and/or substituted, except as provided for in Chapter 11, Section 6 of the Dog Show Rules. All entries MUST be complete.  
 No phone, fax or credit card entries accepted. **All express mail entries must contain signature permitting them to be left without recipient signature.**

**Make checks payable to: MCKC (Manitowoc County Kennel Club)**

Mail entries to **TRIAL SECRETARY: Kathy Dachlet**  
 7821 Morrison Road, Greenleaf WI 54126

**(920) 864-2752** **k9secretary@centurytel.net**

\*\*\*\*\*

**Additional Exhibitor Information**

- All dogs must be on leash at all times except when in the ring or in the designated warm-up area.
- Pinch collars, electric or dummy collars are prohibited. Training collars are allowed.
- The safety of the dogs and handlers is our primary concern. By entering this trial, exhibitors acknowledge that they are familiar with the rules and regulations of the sport and that their dogs are familiar with and able to perform all obstacles safely.
- A warm-up area, consisting of a regulation agility jump, will be provided.
- If your bitch goes into season after the closing date, a full refund of entry fees (less \$5.00 administrative fee per day) will be given. Please notify the trial secretary that your bitch has come into season.
- Entry fee for a dog that is injured after the closing date will be refunded (less \$5.00 administrative fee, AKC service fee and judge's fee per day) if a veterinarian's certificate is presented to the Trial Secretary prior to the start of judging.
- No entry fee will be refunded if the trial cannot open or be completed by reason of fire, civil disturbances, an Act of God, public emergency or any other cause beyond the control of the Club.
- The owner or handler is solely responsible for having the dog ready at ringside when it is to be judged.
- It is expressly understood that exhibitors are responsible for the behavior of themselves, their dogs and their children. Any exhibitor whose dogs or children create an unnecessary disturbance, may, at the discretion of the trial committee, be asked to leave the site. In such a case, no refund of any fee paid will be made. Manitowoc County Kennel Club, and the trial secretary and their members, agents, etc. will assume no responsibility for any loss, damage or injury sustained by exhibitors or handlers, or to any of their dogs or property, and further assumes no responsibility for injury to children.
- Entry fees will not be refunded in the event that a dog is absent, disqualified, excused or barred from the competition by action of the trial committee.

### Regular & Preferred Agility Classes

The dog must be entered only in Regular classes or in Preferred classes, with no crossover between them being allowed at the same set of trials.

**Regular** Novice Standard, JWW & FAST and **Preferred** Novice Standard, JWW & FAST (divided classes A & B)  
**Regular** Open Standard, JWW & FAST and **Preferred** Open Standard, JWW & FAST  
**Regular** Excellent Standard, JWW & FAST and **Preferred** Excellent Standard, JWW & FAST  
**Regular** Master Standard, JWW & FAST and **Preferred** Master Standard, JWW & FAST  
**Regular** T2B and **Preferred** T2B  
**Regular** Premier Standard & JWW and **Preferred** Premier Standard & JWW

### Dogs Eligible to Enter

This trial is open to all dogs over the age of 15 months that are registered with the AKC or that have AKC Limited Registration, are Purebred Alternative Listing/Indefinite Listing Privileges PAL/ILP registered or approved Foundation Stock Service (FSS) breeds, except bitches in season, aggressive dogs or dogs suffering from any deformity, injury or illness which may affect the dog's physical or mental performance. These events are accepting entries for Mixed Breed dogs enrolled in the AKC Canine Partners Program. Refer to Chapter 2 of the Registration and Discipline Rules for the listing of registerable breeds that may participate.

### Height Divisions

Owners are responsible for entering the proper height division. Handlers may opt to run in a higher height division (Regular classes), but not in a division lower than their proper jump height.

<u>Height at Withers</u>	<u>Jump Height Regular Classes</u>	<u>Jump Height Preferred Classes</u>
11" and under	8 inches	4 inches
14" and under	12 inches	8 inches
18" and under	16 inches	12 inches
22" and under	20 inches	16 inches
Over 22"	24 inches	20 inches

26 inch jump height may be entered at the owner's discretion

### Measuring & Height Card Information

When filling out the entry form, there is a section of the form for exhibitors to designate whether your dog has a valid jump height card or if your dog needs to be measured. Please check the appropriate box so that the Trial Secretary knows whether to include your dog on the *Dogs To Be Measured List*. It is no longer required that a copy of your dog's jump height card be submitted with an entry form or show it at check-in; although exhibitors are required to have the official form/card with them at the trial to present upon request. Additionally, if a measurement is necessary, it is the exhibitor's responsibility to have their dog measured prior to running. **Regulations for Agility Trials, Chapter 2, Section 4.**

### Obstacles & Course Familiarization

Obstacles shall meet the specifications for obstacles in the current edition of Regulations for Agility Trials. Contacts & table are rubberized and weaves are 24 inches on center. Obstacle familiarization for Novice dogs will **not** be offered at this trial. Handlers in all classes are permitted to walk the course, without a dog, prior to the start of the class. A walk through will be held prior to each class in conjunction with the judge's briefing.

### Site Information

Site is **OUTDOORS on grass**. There are two rings, which alternate; size of each ring is 80' x 120'. The rings will be enclosed with snow fencing, and the rings are in a chain-link fenced area. There is limited shade; please bring your own shade and tenting. The building (heated/air conditioned) will be available for indoor crating. **DOGS MAY NOT BE LEFT OVERNIGHT.** Crates may be left overnight, however, Manitowoc County Kennel Club, nor the trial secretary will not be responsible for any lost or damaged items left at the trial site.

**Food and beverages will be available for purchase on Saturday & Sunday.**

### Prizes & Awards

Rosettes will be awarded to First through Fourth place in all classes. A qualifying ribbon will be awarded to all dogs with a qualifying score. New Title rosettes, Master Double Qualifier rosettes, MACH rosettes, PACH rosettes and PAX rosettes will also be awarded to teams achieving one of these titles. MACH, PACH & PAX bars will also be awarded to teams achieving one of those titles. All prizes and awards must be claimed the day of the trial – none will be mailed.

### Veterinarian On Call

**Memorial Drive Veterinary Clinic:** 1415 Memorial Drive \* Manitowoc WI 54220 \* 920-682-6558

Hours: 8:00 am – 5:00 pm Saturday 8:00 am – 12:00 Noon Closed Sunday – on call when closed

Exhibitors should follow their veterinarians' recommendation to assure their dogs are free of internal and external parasites, any communicable diseases, and have appropriate vaccinations. Wisconsin laws require dogs over 4 months of age to have current Rabies vaccination.

### Volunteer Worker Sign-Up Form

We are using the internet for our volunteer sign up. The MySignUp page will be open to start signing up for jobs 10 days prior to the trial and will close for signups on Thursday, June 8.

- Go to [www.wejoinin.com/lbusse1463@gmail.com](http://www.wejoinin.com/lbusse1463@gmail.com) to access the worker schedule for each day. You can then sign up for the classes you would like to work at the times you would like to work.
- If you do not have an email address or access to the internet, please contact Lynn Busse at 920-725-4424.

We need your help in ensuring the success of these trials. Please volunteer to help us by completing signing up to work. Your generosity is greatly appreciated 😊

Please direct any questions or problems with the sign-up page to the volunteer coordinator: Lynn Busse ([lbusse1463@gmail.com](mailto:lbusse1463@gmail.com))

### **K9 Secretarial Services by KAD**

Kathy Dachlet



7821 Morrison Road  
Greenleaf, WI 54126  
920-864-2752

[k9secretary@centurytel.net](mailto:k9secretary@centurytel.net)

### Directions to Manitowoc County Kennel Club

**From South:** Take I-43 to exit #152 (Waldo Blvd). Turn East and go 3.5 miles to North 8<sup>th</sup> Street. Turn North (left) and go 1.2 miles to Albert Drive. Turn East (right) and go 0.7 miles to the club grounds on the left.

**From West:** Take US Hwy 10 to I-43. Road now becomes Hwy 310; continue 3.5 miles to County Hwy B (3<sup>rd</sup> roundabout). Turn South (right) and go 2 miles to Albert Drive. Turn East (left) and go 0.7 miles to the club grounds on the left.

**From North:** Take I-43 to Exit #154. Turn East (left) on Hwy 310. Follow "From West" directions above.

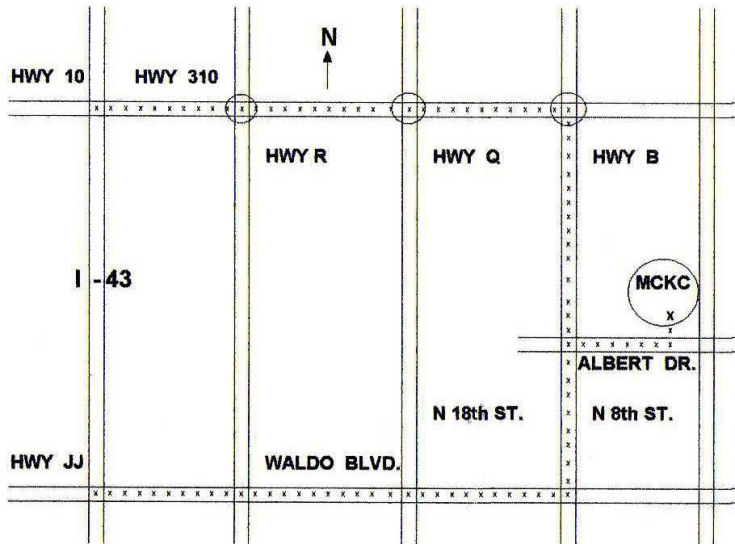

### Motels

The following motels will accept well-behaved dogs with the owner assuming all responsibility. Reservations are subject to house rules of individual motels and may limit to size and require a deposit. Please do not allow your dog(s) to become a nuisance or leave them unattended in a room. Crates, clean up and courtesy are a must to maintain a responsible relationship with our motels.

Mention the club and event name for a rate discount or check online at [hotels.com](http://hotels.com) for their discount rate

Quality Inn of Manitowoc	2200 S. 44 <sup>th</sup> Street, Manitowoc WI 54220	920-683-0220
Holiday Inn	4601 Calumet Avenue, Manitowoc WI 54220	920-682-6000
Best Western Lakefront Hotel	101 N. Maritime Drive, Manitowoc WI 54220	920-682-7000
Lighthouse Inn	1515 Memorial Drive, Two Rivers WI 54241	920-793-4524
Harbor Town Inn	4004 Calumet Avenue, Manitowoc WI 54220	920-684-7841
Village Inn	3310 Memorial Drive, Two Rivers WI 54241	920-794-8818

### Move-Up Regulations & Form

Dogs may be moved up to a higher class at the request of the owner, as a result of qualifying for an agility title. However, written notice (regular mail or e-mail) must be given to the Trial Secretary **no later than 6:00 p.m. CDT on Monday, September 11, 2017. Day-to-day move ups will be allowed if received before the close of the Friday or Saturday trial** (award of ribbons for the last class of the day will be considered the close of the trial). Move-ups will be added to the end of the running order of the class they move up to and every effort will be made to accommodate handlers running multiple dogs in the same class.

**No verbal changes will be accepted. Written requests must include the information listed below.**

Please note that if you do request a move up from a **Novice A class to Open**, prior to the closing date of this trial, AKC regulations state any other class you may be entered in needs to be moved to the **Novice B class**. A dog which has been entered in Novice A, but is ineligible due to restrictions on the dog or handler, may be moved to Novice B **under the following conditions**: The request must be made in writing and presented to the trial secretary at least 30 minutes prior to the start of the trial **AND** the request must state the reason and justification for the move.

After the close of entries, a dog may be moved down in their class level (i.e., Master to Excellent). The request for the move to the class for which the dog is eligible must be in writing and submitted to the trial secretary at least 30 minutes prior to the start of the trial.

Fill out one form **per dog** and send to the Trial Secretary [mailed to standard (7821 Morrison Rd, Greenleaf WI 54126) or e-mail address ([k9secretary@centurytel.net](mailto:k9secretary@centurytel.net))]. Forms must be received by 6:00 p.m. CDT Monday, September 11, 2017. This change form is only for dogs whose entries have been accepted for the Manitowoc County Kennel Club agility trials on September 15-17, 2017.

AKC Registered Name: \_\_\_\_\_

AKC Registration #: \_\_\_\_\_

Breed/Variety: \_\_\_\_\_ Call Name: \_\_\_\_\_

Owner(s): \_\_\_\_\_

Height Division: 4" 8" 12" 16" 20" 24" 26"

Please Circle Appropriate Selections on **EACH** Line

<b>Division:</b>	<b>Regular or Preferred</b>			
<b>Class:</b>	<b>Standard</b>		<b>JWW</b>	
<b>Day:</b>	<b>Friday</b>	<b>Saturday</b>	<b>Sunday</b>	
<b>Current Entry:</b>	Nov A	Nov A or B	Open	Exc
<b>Move To:</b>	Nov B	Open	Exc	Master



AMERICAN  
KENNEL CLUB®

OFFICIAL AMERICAN KENNEL CLUB AGILITY ENTRY FORM  
**Manitowoc County Kennel Club**

	STD	JWW	T2B	Premier
Friday, Sept 15, 2017	STD	JWW	T2B	Premier
Saturday, Sept 16, 2017	STD	JWW	T2B	
Sunday, Sept 17, 2017	STD	JWW		Premier

**Entry Fees:** \$18.00 for 1st entry of a dog; \$17.00 each additional entry of same dog same day; \$12.00 for each entry of a dog with a junior handler (includes AKC event service fees). Entries are on a first received basis. Any entries received prior to the opening date and time will be returned.

**Entries Open:** Saturday July 1, 2017 - 8:00 A.M. CDT at the office of the trial secretary.

**Entries Close:** Friday, September 1, 2017 - 6:00 P.M. CDT at the office of the trial secretary. No phone, fax, or credit card entries will be accepted. All express mail entries must have signature permitting receipt without recipient signature.

**Make Checks and or Money Orders payable to:** MCKC.

**Mail entries with fees to:** Kathy Dachlet; 7821 Morrison Road; Greenleaf, WI 54126. 920-864-2752

**IMPORTANT: Carefully read instructions before filling out!**

**ENTRY FEE ENCLOSED**

\$

**Choose Either Regular or Preferred Classes**

Check one jump height, and check class selections – Only one selection per class (both Master and Premier allowed)

REGULAR Classes							PREFERRED Classes				
8"	12"	16"	20"	24"	26"		4"	8"	12"	16"	20"
STD	Nov A	Nov B	Open	Exc	Master	Premier	Nov P	OpenP	ExcP	MasterP	PremierP
JWW	Nov A	Nov B	Open	Exc	Master	Premier	Nov P	OpenP	ExcP	MasterP	PremierP
FAST	Nov A	Nov B	Open	Exc	Master		Nov P	OpenP	ExcP	MasterP	
T2B	T2B		T2BP								

~~Non-Regular Classes International Sweepstakes STD JWW~~

~~ISC Jump Height Select: 14" 18" 26" OR Jump Height Same as Regular/Preferred~~

This dog needs to be measured:	Yes	No	SEX	HEIGHT AT WITHERS
BREED	VARIETY		CALL NAME	

AKC® NAME (include AKC titles only)

<input type="checkbox"/> AKC NO.	(Enter Complete Registration # below)	DATE OF BIRTH
<input type="checkbox"/> ILP NO.	<input type="checkbox"/> PAL NO.	PLACE OF BIRTH (List Country)
<input type="checkbox"/> FOREIGN REG. NO. & COUNTRY		

BREEDER

SIRE

DAM

ACTUAL OWNERS

OWNERS ADDRESS NEW ADDRESS

CITY STATE ZIP + 4

HANDLER ENTER JR. HANDLER # if applicable

**Exhibitor or owner MUST sign on the signature line beneath the instructions.**

AKC Rules, Regulations, Policies and Guidelines are available on the American Kennel Club Web site, [www.akc.org](http://www.akc.org)

**AGREEMENT**

I certify that I am the actual owner of the dog, or that I am the duly authorized agent of the actual owner whose name I have entered. In consideration of the acceptance of this entry, I (we) agree to abide by the rules and regulations of The American Kennel Club in effect at the time of this event, and any additional rules and regulations appearing in the premium list of this event and entry form and any decision made in accord with them. I (we) agree that the club holding this event has the right to refuse this entry for cause which the club shall deem sufficient. I (we) certify and represent that the dog entered is not a hazard to persons or other dogs. In consideration of the acceptance of this entry and of the holding of this event and of the opportunity to have the dog judged and to win prizes, ribbons, or trophies, I (we) agree to hold the AKC, the event-giving club, their members, directors, governors, officers, agents, superintendents or event secretary and the owner and/or lessor of the premises and any provider of services that are necessary to hold this event and any employees or volunteers of the aforementioned parties, and any AKC approved judge, judging at this event, harmless from any claim for loss or injury which may be alleged to have been caused directly or indirectly to any person or thing by the act of this dog while in or about the event premises or grounds or near any entrance thereto, and I (we) personally assume all responsibility and liability for any such claim; and I (we) further agree to hold the aforementioned parties harmless from any claim for loss, injury or damage to this dog.

Additionally, I (we) hereby assume the sole responsibility for and agree to indemnify, defend and save the aforementioned parties harmless from any and all loss and expense (including legal fees) by reason of the liability imposed by law upon any of the aforementioned parties for damage because of bodily injuries, including death at any time resulting therefrom, sustained by any person or persons, including myself (ourselves), or on account of damage to property, arising out of or in consequence of my (our) participation in this event, however such, injuries, death or property damage may be caused, and whether or not the same may have been caused or may be alleged to have been caused by the negligence of the aforementioned parties or any of their employees, agents, or any other person. I (we) agree that the determination of whether the injury is serious shall be made by the event veterinarian and is binding on me (us). **I (WE) AGREE THAT ANY CAUSE OF ACTION, CONTROVERSY OR CLAIM ARISING OUT OF OR RELATED TO THE ENTRY, EXHIBITION OR ATTENDANCE AT THE EVENT BETWEEN THE AKC AND THE EVENT-GIVING CLUB (UNLESS OTHERWISE STATED IN THIS PREMIUM LIST) AND MYSELF (OURSELVES) OR AS TO THE CONSTRUCTION, INTERPRETATION AND EFFECT OF THIS AGREEMENT SHALL BE SETTLED BY ARBITRATION PURSUANT TO THE APPLICABLE RULES OF THE AMERICAN ARBITRATION ASSOCIATION. HOWEVER, PRIOR TO ARBITRATION ALL APPLICABLE AKC BYLAWS, RULES, REGULATIONS AND PROCEDURES MUST FIRST BE FOLLOWED AS SET FORTH IN THE AKC CHARTER AND BYLAWS, RULES, REGULATIONS, PUBLISHED POLICIES AND GUIDELINES.**

**INSTRUCTIONS**

Handlers may opt to enter in a higher **height division** for all **Regular** titling classes, but not in a division lower than their proper height division. Dogs entered in the **Preferred** classes **must** compete at the required jump height and **may not** compete in a jump height division **higher or lower** than their proper height division.

All dogs that have not been officially measured for an **Agility Jump Height Card** may still compete; however, they must be measured by a Judge of record, an Agility Field Representative, or a Volunteer Measuring Official, prior to running. If measured by the judge of record, that measurement will be valid for this trial or **back-to-back trials** only. If a measurement is necessary, it is the exhibitor's responsibility to have their dog(s) measured prior to running.

Dogs listed in the **AKC Canine Partners Program<sup>SM</sup>** may be eligible to enter all-breed AKC agility trials at the club's option. These dogs should be listed as All American Dog and must include their AKC number on the entry form and check the AKC No. box.

**Junior Handlers** should enter their Junior Handler Number on the front of this form. Should you not have your Junior Handler number, it may be obtained from the American Kennel Club (919) 233-9767. If the Junior Handler is not the owner of the dog identified on the face of this form, what is the relationship of the Junior Handler to the Owner?

**SIGNATURE** of owner or his agent duly authorized to make this entry.

**SIGN HERE X** \_\_\_\_\_

Telephone Number: \_\_\_\_\_ *New Email*

Email: \_\_\_\_\_

In Case of Emergency - Name: \_\_\_\_\_ Phone #: \_\_\_\_\_